



# KAB terminal block label



## Product information

KAB - for terminal manufacturers Allen Bradley, ABB Entelec, Lütze, Woertz and Weidmüller (WDU, WPU).  
High-quality, halogen-free snap-in label plates. Labels available for mounting individually or in strips.

The large printable area at the top allows room for individual project and terminal block reference, without the need for additional organizational systems.

## Information, conformities and approvals

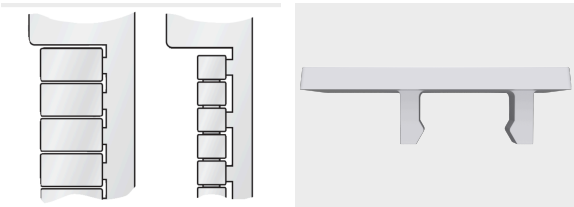

Article	Order No.	Color	RAL similar	Label size * mm	Printable area* mm	Number of characters / lines	Quantity per frame	Base plate	Software Article	PU pcs.
Single labels										
KAB 6/12	86402014	White	9016	6 x 12	6 x 12	6 / 1	72	GP4	112	1000
5 mm pitch strips in a row										
KAB 5/5.4-5	86402004	White	9016	5 x 5.4	5 x 5.4	3 / 1	110	GP5 Single tree adapter 5	55	1430
KAB 5/9-5	86402006	White	9016	5 x 9	5 x 9	5 / 1	88	GP4	110	1400
KAB 5/12-5	86402008	White	9016	5 x 12	5 x 12	6 / 1	88	GP4	111	1400
6 mm pitch strips in a row										
KAB 6/9-6	86402010	White	9016	6 x 9	6 x 9	5 / 1	72	GP4	50	1000
KAB 6/10-6	86402022	White	9016	6 x 10	6 x 10	5 / 1	72	GP4	56	1000
KAB 6/12-6	86402012	White	9016	6 x 12	6 x 12	6 / 1	72	GP4	51	1000
8 mm pitch strips in a row										
KAB 8/9-8	86402016	White	9016	8 x 9	8 x 9	5 / 2	52	GP4	53	1040
KAB 8/12-8	86402018	White	9016	8 x 12	8 x 12	6 / 2	52	GP4	54	1040



## KAB terminal block label

### Material properties



Polycarbonate (PC) ||

### Thermal properties



Temperature / temperature range -40 °C – 130 °C

### Fire properties



Fire classification V0

### Technical information



Halogen-free

### Classification



ETIM 9: EC000761 || eClass 14: 27281101 || UNSPSC: 39131504 ||

### General technical data



Assembly method 0000000011000

### Assembly method



Snap-fit system



Strip system

### Labelling technology



Plotter



Laser



Inkjet



## KAB terminal block label