



Flange clamp



Product information

The flange clamps allow tension clamps R-SSR and precision pipes R-RG or R-RW to be connected with other components. Clamping on the entire pipe circumference. The flange clamp R-FKD can be used to mount system holders with a swivel range of 36°. The position of the swivel range is adjustable. This prevents bending of the protection conduit. With the flange clamp type R-FKE, the system holder is fixed rigidly. For the flange clamps R-FKM, the base plate R-FKG or the swivel bearing R-DZM is additionally required for fixing a system holder.

Information, conformities and approvals

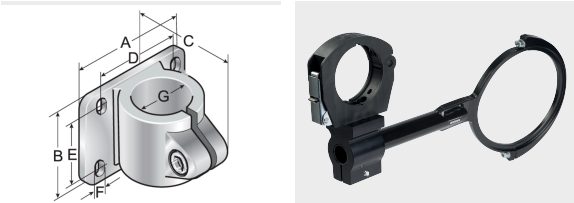

Article	Order No.	Color	A mm	B mm	C mm	D Angle °	E mm	F mm	G mm	PU pcs.
R-FKD 32	83952616	Black anodized	60	60	112				32	1
R-FKE 32	83952614	Black anodized	60	60	93				32	1
R-FKM 32 1)	83952610	Silver	105	80	85	80	58	8.5	32	1
R-FKM 40 1)	83952612	Silver	105	80	85	80	58	8.5	40	1

1) Adapter plate R-FKG is required for the installation of a system holder.

Material properties

Aluminium II

Conformity

RoHS

RoHS (EC Directive 2011/65/EU)



Flange clamp

Approvals and operating permits



ROBI approval

Classification



ETIM 9: EC000127 || eClass 14: 23140107 || UNSPSC: 31162814 ||

General information



Made in Germany