

Product designation				Enclosed rotary cam switch
Product type designation				7GN40
General characteristics				
Switching diagram				11 - 3-phase motor reversing switch
N° of elements				3
Mounting form				P25 - Plastic enclosure with red/yellow handle
Contact characteristics				
Rated insulation voltage Ui		IEC/EN UL/CSA	V V	690 600
Rated impulse withstand voltage Uimp			kV	6
Conventional free air thermal current Ith		IEC/EN UL/CSA	A A	40 50
Rated operational voltage			V	480
Rated operational impulse voltage			kV	4
Maximum fuse size for short-circuit protection In (gG)		10kA 15kA 25kA 50kA 63kA	A A A A A	40 40 40 40 40
Rated short time current Icw		1s	kA	1000
Conductivity	10/5 mA/V			
Operational current Ie IEC/EN				
AC1/AC21A			A	40
AC15		110V 220/230V 380/400V 660/690V	A A A A	25 22 12 2
Rated operational power in AC				
Three-phase AC-3		220/230V 380/440V 500/690V	kW kW kW	8 15 15
Single-phase AC-3		110V 220/230V 380/440V	kW kW kW	3 6.5 8
Three-phase AC23A		220/230V 380/440V 500/690V	kW kW kW	8 18.5 22
Single-phase AC23A		110V	kW	3

ENCLOSED ROTARY CAM SWITCH 7GN SERIES, 3-PHASE MOTOR REVERSING SWITCH  
40A IN PLASTIC ENCLOSURE 110X110MM WITH RED/YELLOW HANDLE

		220/230V	kW	6
		380/440V	kW	11
Rated operational current in DC				
DC21A				
		48V	A	40
		60V	A	40
		110V	A	6
		220V	A	0.9
DC23A (poles in series)				
		24V	A	40 (1)
		48V	A	40 (2)
		60V	A	40 (3)
		110V	A	20 (3)
		220V	A	12 (4)
DC13				
		24V	A	40
		48V	A	32
		60V	A	16
		110V	A	3
Power dissipation			W	2.0
Mechanical features				
Terminals screw				M4
Tightening torque for terminals max			Nm	1.2
Conductor size				
AWG - Rigid cable				
		min	AWG	16
		Max	AWG	8
AWG - Flexible cable				
		min	AWG	16
		Max	AWG	10
Conductor size (IEC) - Flexible cable				
		min	mm <sup>2</sup>	1.5
		Max	mm <sup>2</sup>	6
Conductor size (IEC) - Rigid cable				
		min	mm <sup>2</sup>	1.5
		Max	mm <sup>2</sup>	10
Mechanical life			cycles	5x10 <sup>6</sup>
UL technical data				
Motor power for direct-on-line control				
for three-phase motor				
		120V	HP	5
		240V	HP	10
		480V	HP	20
		600V	HP	20
for single-phase motor				
		120V	HP	2
		240V	HP	5
Ambient conditions				
Temperature				
Operating temperature				
		min	°C	-25
		max	°C	+55
Storage temperature				
		min	°C	-40

max °C +70

## Resistance & Protection

Frontal IP degree IP65

Terminals IP degree IP00

## Dimensions

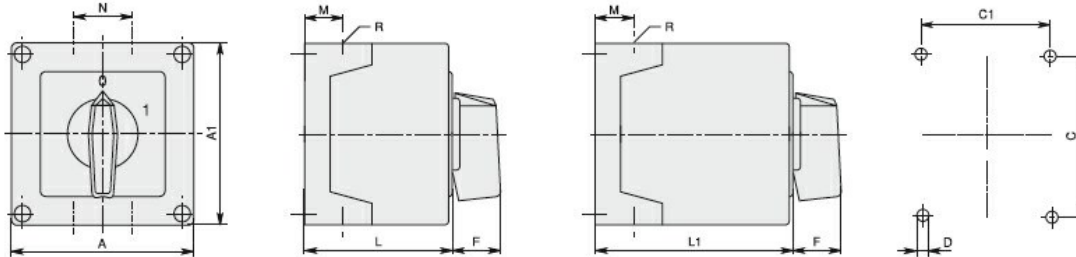

Series	Enclosure size	Number of elements		Dimensions										Cable entry	Protection degree
		L	L1	A	A1	C	C1	D	F	M	N	L	L1		
7GN12	75x75	1 - 2	3 - 4	75	75	50	64	4.5	19	14	28	57.5	79.8	4xPG13.5	IP65
7GN20		1 - 2	3 - 4												
7GN25		1	2 - 3												
7GN12	90x90	1 - 3	4 - 6	90	90	79	63	4.5	25	19	30	71.3	98.3	4xPG16	IP65
7GN20		1 - 3	4 - 6												
7GN25		1 - 2	3 - 4												
7GN32		1 - 2	3 - 4												
7GN40	110x110	1	2 - 3	110	110	98.4	83	4.5	32	21	39.5	85.5	119.5	4xPG21	IP65
7GN12		1 - 4	5 - 8												
7GN20		1 - 4	5 - 8												
7GN25		1 - 3	4 - 5												
7GN32		1 - 3	4 - 5												
7GN40		1 - 2	3 - 5												
7GN63	125x175	1 - 2	3 - 4	125	175	146	112	5.5	32	21	68	84.3	118.3	4xPG21 2xPG11	IP65
7GN32		1 - 3	4 - 5												
7GN40		1 - 2	3 - 4												
7GN63		1 - 2	3 - 4												
7GN125	180x254	1	2	180	254	120	190	5.5	32	35	76	121	175	4xPG29 2xPG11	IP65
7GN32		1 - 5	6 - 8												
7GN40		1 - 4	5 - 7												
7GN63		1 - 3	4 - 6												
7GN125		1 - 2	3 - 4												

## Wiring diagrams

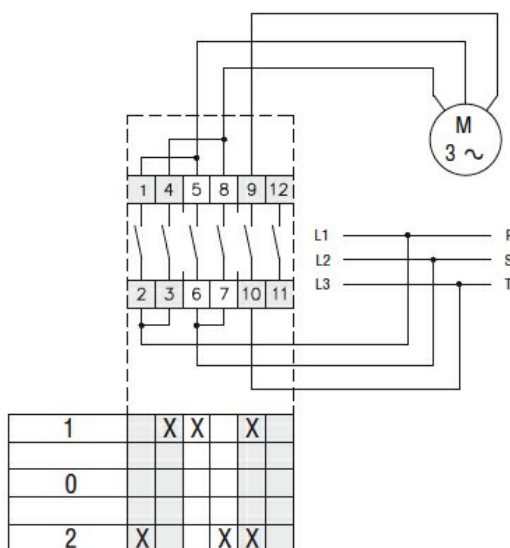

## Certifications and compliance

### Compliance

IEC/EN/BS 60947-1

IEC/EN/BS 60947-3

IEC/EN/BS 60947-5-1

---

Certificates

EAC

ETIM classification

ETIM 8.0

EC001029 -  
Selector switch,  
complete