

Series M22

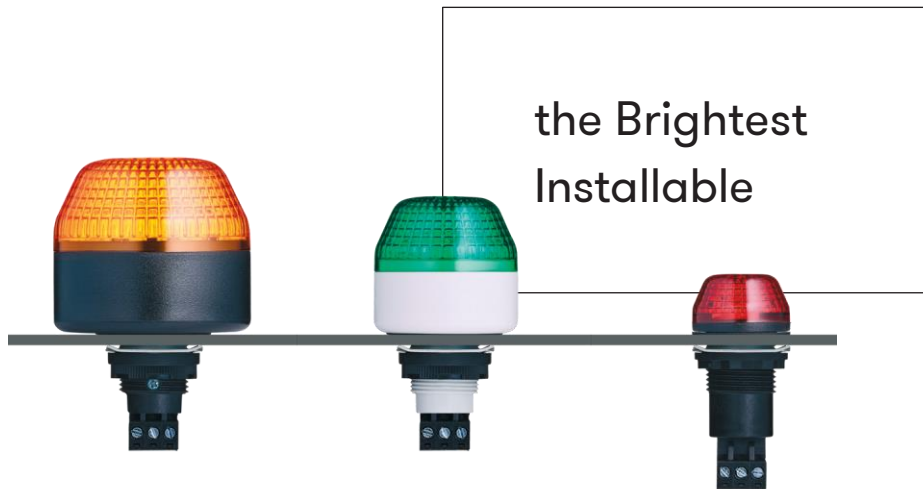

FEATURES

- Ø 30/45/65 mm | 1.18/1.77/2.56 Inch led panel mount beacons
- IP65 in panel mount condition
- light functions externally switchable via terminal
- excellent front/side signalling effect
- dual and triple colour models also available
- excellent price/performance ratio
-

INDUSTRY/APPLICATION

- for industrial and general applications
- for switch cabinet/panels and enclosures
- for versatile applications in practically all industries

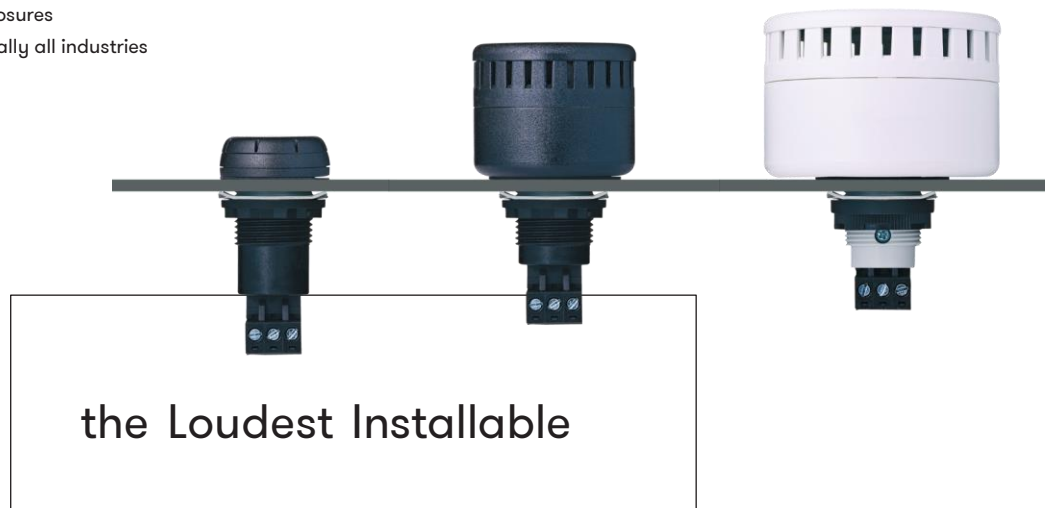

FEATURES

- IP65 in panel mount condition
- 2 respectively 3 tone types externally switchable
- sound pressure infinitely adjustable (ESM/ESG), even in panel mount condition
- excellent price/performance ratio

INDUSTRY/APPLICATION

- for switch cabinet/panels and enclosures
- for versatile applications in industrial/general applications

Series M22

FEATURES

- standard models with synchronized tone and light
- (continuous tone/led steady light - pulsing tone/led flashing light)
- high IP65 rating in panel mount condition
- sound pressure infinitely adjustable even in panel mount condition
- excellent price/performance ratio
- optional models available with separately switchable tone and light

INDUSTRY/APPLICATION

- for switch cabinet/panels and enclosures
- for versatile applications in industrial/general applications too

the loudest &
brightest installable

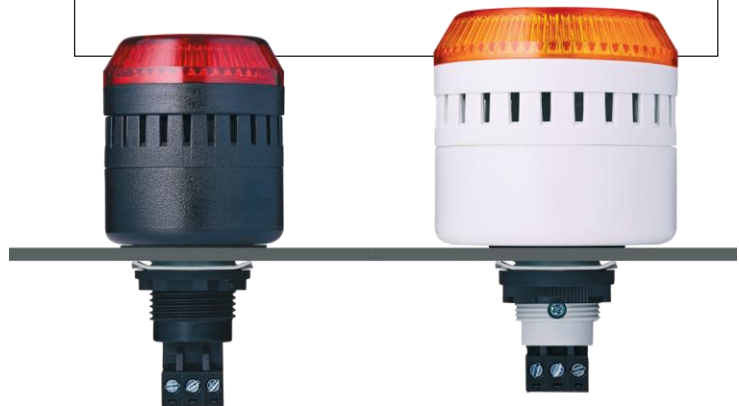

ISS M22 panel mount LED strobe beacon

- Ø 30 mm | 1.18 Inch panel-mount LED strobe beacon
- Good signalling effect
- High degree of protection IP 65
- User-friendly connection technology thanks to plug-in screw terminal
- Modern LED technology and electronics
- For industrial and general applications
- Panel size Ø 22.5 mm | 0.89 Inch /M22
- Adapter available for M 30.5 mm | 1.2 Inch panel size



TECHNICAL DATA

Housing	Ø 30 mm 1.18 Inch, Polycarbonate black (RAL 9005) or grey (RAL 7035)
Lens	Polycarbonate, ribbed inside amber or red
Type of mounting	any
Panel size	22x1,5 mm 0.87x0.06 Inch (M22) and 30.5 mm 1.2 Inch (with adapter), mounting depth 47 mm 1.85 Inch
Connection technology	Screw/plug-in terminal 2,5 mm ²
Leakage current	3 mA (PLC-suitable)
Beacon type	LED strobe beacon
Light source	6 LEDs Strobe/flash frequency 1 Hz
Duty cycle	100%
Service life	Light source: 100.000 h
Operating temperature	-25°C/+60°C 13 °F / 140 °F
Degree of protection	IP65 & UL Type 4/4x/13

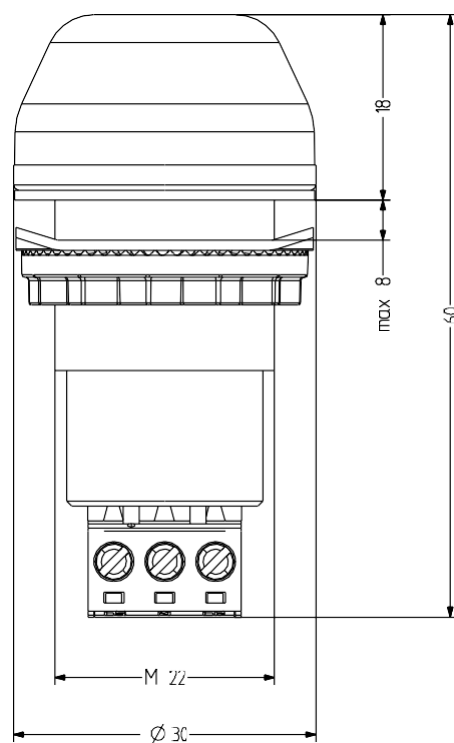

ISS

ORDER DATA

Lens colour	Nominal voltage	Voltage range (V)	Nominal current (mA)	Housing colour	
				black	grey
amber	12 V AC/DC	+/- 10 %	60	800 511 404	800 111 404
	24 V AC/DC	+/- 10 %	46	800 511 405	800 111 405
	110-120 V AC/DC	+/- 10 %	18	800 511 310	800 111 310
	230-240 V AC/DC	+/- 10 %	21	800 511 313	800 111 313
red	12 V AC/DC	+/- 10 %	60	800 512 404	800 112 404
	24 V AC/DC	+/- 10 %	46	800 512 405	800 112 405
	110-120 V AC/DC	+/- 10 %	18	800 512 310	800 112 310
	230-240 V AC/DC	+/- 10 %	21	800 512 313	800 112 313



ACCESSORIES

Type	Type of accessory	Weight	Order number
ADM30	Adapter for M30.5 mounting holes	8 g 0.02 lbs	812 500 900
WZ30	Mounting tool for M22 mounting products with Ø 30 mm 1.18 Inch		812 400 900
WM22	Metal bracket for products with M22 mounting thread	45 g 0.1 lbs	812 100 900

ICM / ICL M22 panel mount LED multi strobe beacon

- Ø 45 mm | 1.77 Inch / Ø 65 mm | 2.56 Inch panel mount LED multi-strobe beacon
- Good signalling effect
- High degree of protection IP 65
- User-friendly connection technology thanks to plug-in screw terminal
- Prewired model versions with IP 67 on request
- Modern LED technology and electronics
- 2 different strobe patterns, can be switched externally
- For industrial and general applications
- Panel size Ø 22.5 mm | 0.89 Inch/M22
- Adapter available for M30.5 mm | 1.2 Inch panel size



TECHNICAL DATA

Housing	Ø 45 mm 1.77 Inch / Ø 65 mm 2.56 Inch Polycarbonate black (RAL 9005) or grey (RAL 7035)
Lens	Polycarbonate, ribbed inside amber or red
Type of mounting	any
Panel size	22x1,25 mm 0.87x0.05 Inch (M22) and 30.5 mm 1.2 Inch (with adapter), mounting depth 34 mm 1.34 Inch
Cable entry	pre-wired at customer's request
Connection technology	Screw/plug-in terminal 2,5 mm ²
Leakage current	3 mA (PLC-suitable)
Beacon type	LED multi strobe beacon
Light source	9 / 12 LEDs
Strobe/flash frequency	Double strobe and 6x strobe
Duty cycle	100 %
Service life	Light source: 100.000 h
Operating temperature	-25°C/+60°C 13 °F / 140 °F
Degree of protection	IP65 & UL Type 4/4x/13

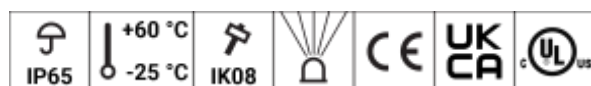

ICM / ICL Order numbers

ICM

Lens colour	Nominal voltage	Voltage range (V)	Nominal current (mA)	Housing colour	
				grey	black
amber	24 V AC/DC	+/- 10 %	110	801 121 405	801 521 405
	110-120 V AC	+/- 10 %	33	801 121 310	801 521 310
	230-240 V AC	+/- 10 %	33	801 121 313	801 521 313
red	24 V AC/DC	+/- 10 %	110	801 122 405	801 522 405
	110-120 V AC	+/- 10 %	33	801 122 310	801 522 310
	230-240 V AC	+/- 10 %	33	801 122 313	801 522 313

ICL

Lens colour	Nominal voltage	Voltage range (V)	Nominal current (A)	Housing colour	
				grey	black
amber	24 V AC/DC	+/- 10 %	155	802 121 405	802 521 405
	110-120 V AC	+/- 10 %	45	802 121 310	802 521 310
	230-240 V AC	+/- 10 %	45	802 121 313	802 521 313
red	24 V AC/DC	+/- 10 %	155	802 122 405	802 522 405
	110-120 V AC	+/- 10 %	45	802 122 310	802 522 310
	230-240 V AC	+/- 10 %	45	802 122 313	802 522 313



ADM30

ACCESSORIES

Type	Type of accessory	Weight	Order number
ADM30	Adapter for M30.5 mounting holes	8 g 0.02 lbs	812 500 900
WM22	Metal bracket for products with M22 mounting thread	45 g 0.1 lbs	812 100 900
WM22I	Indoor Metal bracket for products with M22 mounting thread	45 g 0.1 lbs	812 100 910

ICM

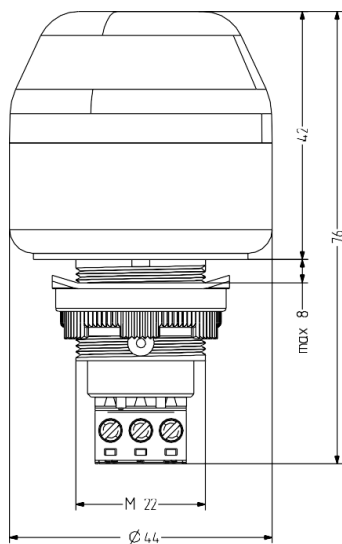

ICL

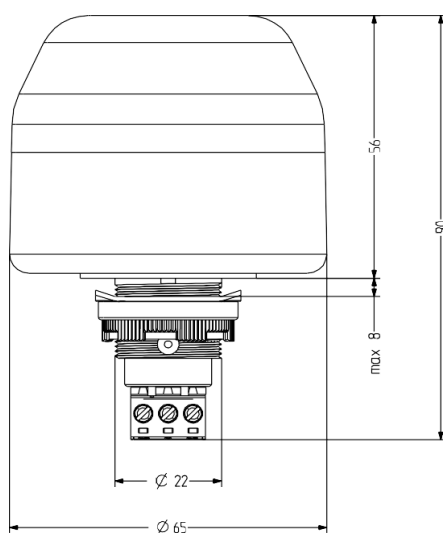

IBS / IBM / IBL M22 panel mount LED steady/flashing beacon

- Ø 30 mm | 1.18 Inch / Ø 45 mm | 1.77 Inch / Ø 65 mm | 2.56 Inch panel mount LED steady/flashing beacon
- Good signalling effect
- High degree of protection IP 65
- User-friendly connection technology
- Adapter available for M30.5 mm | 1.2 Inch panel size
- Modern LED technology and electronics
- Steady/flashing light, can be switched externally
- For industrial and general applications
- Panel size Ø 22.5 mm | 0.89 Inch/M22



TECHNICAL DATA

Housing	Ø 30 mm 1.18 Inch / Ø 45 mm 1.77 Inch / Ø 65 mm 2.56 Inch Polycarbonate black (RAL 9005) or grey (RAL 7035)
Lens	Polycarbonate, ribbed inside amber, red, clear, blue, green or yellow
Type of mounting	any
Panel size	22x1,5 0.87x0.06 Inch (M22) and 30.5 mm 1.2 Inch (with adapter), mounting depth 47 mm 1.85 Inch
Connection technology	Screw/plug-in terminal 2,5 mm ²
Leakage current	3 mA (PLC-suitable)
Beacon type	LED steady beacon or LED flashing beacon
Light source	6 / 9 / 12 LEDs
Strobe/flash frequency	2 Hz
Duty cycle	100%
Service life	Light source: 100.000 h
Operating temperature	-25°C/+60°C 13 °F / 140 °F
Degree of protection	IP65 & UL Type 4/4x/13
Weight	30 / 55 / 75 g 0.07 / 0.12 / 0.17 lbs

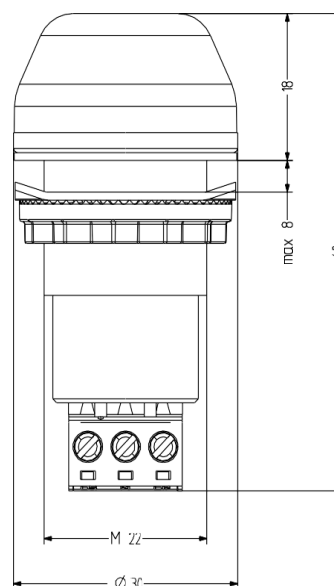

IBS / IBM / IBL Order numbers

IBS

Lens colour	Nominal voltage	Voltage range (V)	Nominal current (mA)	Housing colour	
				grey	black
amber	12 V AC/DC	+/- 10 %	45	800 101 404	800 501 404
	24 V AC/DC	+/- 10 %	26	800 101 405	800 501 405
	110-120 V AC	+/- 10 %	18	800 101 310	800 501 310
	230-240 V AC	+/- 10 %	19	800 101 313	800 501 313
red	12 V AC/DC	+/- 10 %	45	800 102 404	800 502 404
	24 V AC/DC	+/- 10 %	26	800 102 405	800 502 405
	110-120 V AC	+/- 10 %	18	800 102 310	800 502 310
	230-240 V AC	+/- 10 %	19	800 102 313	800 502 313
clear	12 V AC/DC	+/- 10 %	45	800 104 404	800 504 404
	24 V AC/DC	+/- 10 %	26	800 104 405	800 504 405
	110-120 V AC	+/- 10 %	18	800 104 310	800 504 310
	230-240 V AC	+/- 10 %	19	800 104 313	800 504 313
blue	12 V AC/DC	+/- 10 %	45	800 105 404	800 505 404
	24 V AC/DC	+/- 10 %	26	800 105 405	800 505 405
	110-120 V AC	+/- 10 %	18	800 105 310	800 505 310
	230-240 V AC	+/- 10 %	19	800 105 313	800 505 313
green	12 V AC/DC	+/- 10 %	45	800 106 404	800 506 404
	24 V AC/DC	+/- 10 %	26	800 106 405	800 506 405
	110-120 V AC	+/- 10 %	18	800 106 310	800 506 310
	230-240 V AC	+/- 10 %	19	800 106 313	800 506 313
yellow	12 V AC/DC	+/- 10 %	45	800 107 404	800 507 404
	24 V AC/DC	+/- 10 %	26	800 107 405	800 507 405
	110-120 V AC	+/- 10 %	18	800 107 310	800 507 310
	230-240 V AC	+/- 10 %	19	800 107 313	800 507 313

IBS / IBM / IBL Order numbers

IBM

Lens colour	Nominal voltage	Voltage range [V]	Nominal current [mA]	Housing colour	
				black	grey
amber	12 V AC/DC	+/- 10 %	62	801 501 404	801 101 404
	24 V AC/DC	+/- 10 %	37	801 501 405	801 101 405
	110-120 V AC	+/- 10 %	30	801 501 310	801 101 310
	230-240 V AC	+/- 10 %	30	801 501 313	801 101 313
red	12 V AC/DC	+/- 10 %	62	801 502 404	801 102 404
	24 V AC/DC	+/- 10 %	37	801 502 405	801 102 405
	110-120 V AC	+/- 10 %	30	801 502 310	801 102 310
	230-240 V AC	+/- 10 %	30	801 502 313	801 102 313
clear	12 V AC/DC	+/- 10 %	62	801 504 404	801 104 404
	24 V AC/DC	+/- 10 %	37	801 504 405	801 104 405
	110-120 V AC	+/- 10 %	30	801 504 310	801 104 310
	230-240 V AC	+/- 10 %	30	801 504 313	801 104 313
blue	12 V AC/DC	+/- 10 %	62	801 505 404	801 105 404
	24 V AC/DC	+/- 10 %	37	801 505 405	801 105 405
	110-120 V AC	+/- 10 %	30	801 505 310	801 105 310
	230-240 V AC	+/- 10 %	30	801 505 313	801 105 313
green	12 V AC/DC	+/- 10 %	62	801 506 404	801 106 404
	24 V AC/DC	+/- 10 %	37	801 506 405	801 106 405
	110-120 V AC	+/- 10 %	30	801 506 310	801 106 310
	230-240 V AC	+/- 10 %	30	801 506 313	801 106 313
yellow	12 V AC/DC	+/- 10 %	62	801 507 404	801 107 404
	24 V AC/DC	+/- 10 %	37	801 507 405	801 107 405
	110-120 V AC	+/- 10 %	30	801 507 310	801 107 310
	230-240 V AC	+/- 10 %	30	801 507 313	801 107 313

IBS / IBM / IBL Order numbers

IBL

Lens colour	Nominal voltage	Voltage range [V]	Nominal current [mA]	Housing colour	
				black	grey
amber	12 V AC/DC	+/- 10 %	80	802 501 404	802 101 404
	24 V AC/DC	+/- 10 %	60	802 501 405	802 101 405
	110-120 V AC	+/- 10 %	30	802 501 310	802 101 310
	230-240 V AC	+/- 10 %	31	802 501 313	802 101 313
red	12 V AC/DC	+/- 10 %	80	802 502 404	802 102 404
	24 V AC/DC	+/- 10 %	60	802 502 405	802 102 405
	110-120 V AC	+/- 10 %	30	802 502 310	802 102 310
	230-240 V AC	+/- 10 %	31	802 502 313	802 102 313
clear	12 V AC/DC	+/- 10 %	80	802 504 404	802 104 404
	24 V AC/DC	+/- 10 %	60	802 504 405	802 104 405
	110-120 V AC	+/- 10 %	30	802 504 310	802 104 310
	230-240 V AC	+/- 10 %	31	802 504 313	802 104 313
blue	12 V AC/DC	+/- 10 %	80	802 505 404	802 105 404
	24 V AC/DC	+/- 10 %	60	802 505 405	802 105 405
	110-120 V AC	+/- 10 %	30	802 505 310	802 105 310
	230-240 V AC	+/- 10 %	31	802 505 313	802 105 313
green	12 V AC/DC	+/- 10 %	80	802 506 404	802 106 404
	24 V AC/DC	+/- 10 %	60	802 506 405	802 106 405
	110-120 V AC	+/- 10 %	30	802 506 310	802 106 310
	230-240 V AC	+/- 10 %	31	802 506 313	802 106 313
yellow	12 V AC/DC	+/- 10 %	80	802 507 404	802 107 404
	24 V AC/DC	+/- 10 %	60	802 507 405	802 107 405
	110-120 V AC	+/- 10 %	30	802 507 310	802 107 310
	230-240 V AC	+/- 10 %	31	802 507 313	802 107 313

ACCESSORIES

Type	Type of accessory	Weight	Order number
ADM30	Adapter for M30.5 mounting holes	8 g 0.02 lbs	812 500 900
WZ30	Mounting tool for M22 mounting products with Ø 30 mm 1.18 Inch		812 400 900
WM22	Metal bracket for products with M22 mounting thread	45 g 0.1 lbs	812 100 900

IBM

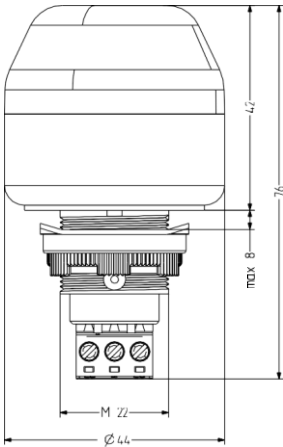

IBL

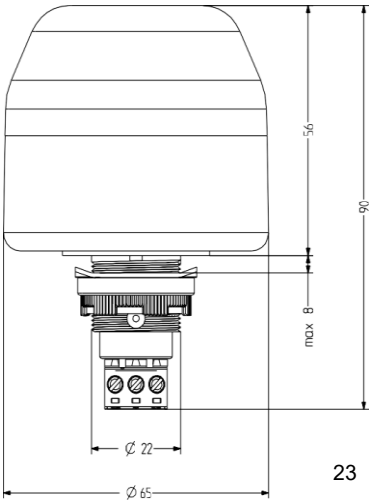

IDS / IDM / IDL M22 panel mount LED multi colour beacon

- Ø 30 mm | 1.18 Inch / Ø 45 mm | 1.77 Inch / Ø 65 mm | 2.56 Inch panel-mount LED multi-colour steady beacon
- RED or GREEN, can be switched externally
- Good signalling effect
- High degree of protection IP 65
- User-friendly connection technology
- Modern LED technology and electronics
- Other colour combinations available on request
- For industrial and general applications
- Panel size Ø 22.5 mm | 0.89 Inch/M22
- Adapter available for M30.5 mm | 1.2 Inch panel size



TECHNICAL DATA

Housing	Ø 30 mm 1.18 Inch / Ø 45 mm 1.77 Inch / Ø 65 mm 2.56 Inch Polycarbonate black (RAL 9005) or grey (RAL 7035)
Lens	Polycarbonate, ribbed inside clear
Type of mounting	any
Panel size	22x1,5 0.87x0.06 Inch (M22) and 30.5 mm 1.2 Inch (with adapter), mounting depth 47 mm 1.85 Inch
Connection technology	Screw/plug-in terminal 2,5 mm ²
Leakage current	3 mA (PLC-suitable)
Beacon type	LED steady beacon - 2 colours, in each case 1 colour visible across whole lens
Light source	6 / 9 / 12 LEDs
Strobe/flash frequency	1 Hz
Number of colours	2
Duty cycle	100%
Service life	Light source: 100.000 h
Operating temperature	-25°C/+50°C 13 °F / 122 °F
Degree of protection	IP65 & UL Type 4/4x/13
Weight	30 / 55 / 75 g 0.07 / 0.12 / 0.17 lbs



IDS

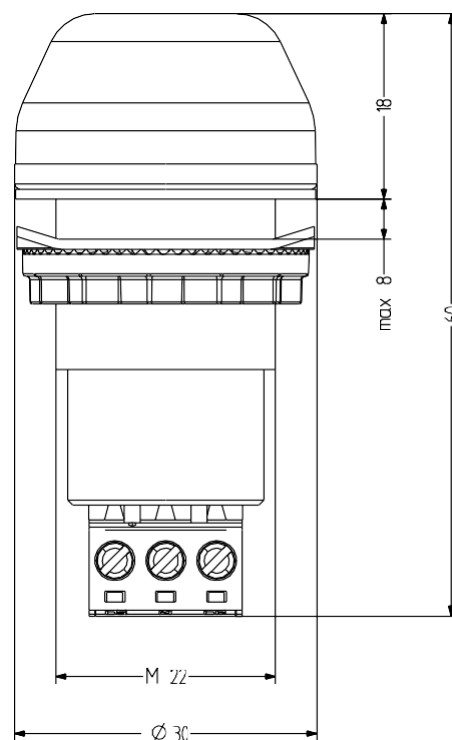

IDS / IDM / IDL Order numbers

IDS

Lens colour	Nominal voltage	Voltage range (V)	Nominal current (mA)	Housing colour	
				grey	black
clear	24 V AC/DC	+/- 10 %	28	800 226 405	800 626 405

IDM

Lens colour	Nominal voltage	Voltage range (V)	Nominal current (mA)	Housing colour	
				black	grey
clear	24 V AC/DC	+/- 10 %	46	801 626 405	801 226 405
	110-120 V AC	+/- 10 %	35	801 626 310	801 226 310
	230-240 V AC	+/- 10 %	35	801 626 313	801 226 313

IDL

Lens colour	Nominal voltage	Voltage range (V)	Nominal current (mA)	Housing colour	
				black	grey
clear	24 V AC/DC	+/- 10 %	71	802 626 405	802 226 405
	110-120 V AC	+/- 10 %	61	802 626 310	802 226 310
	230-240 V AC	+/- 10 %	61	802 626 313	802 226 313



ADM30



WZ30

ACCESSORIES

Type	Type of accessory	Weight	Order number
ADM30	Adapter for M30.5 mounting holes	8 g 0.02 lbs	812 500 900
WZ30	Mounting tool for M22 mounting products with Ø 30 mm 1.18 Inch		812 400 900
WM22	Metal bracket for products with M22 mounting thread	45 g 0.01 lbs	812 100 900
WM22I	Indoor Metal bracket for products with M22 mounting thread	45 g 0.1 lbs	812 100 910

IDM

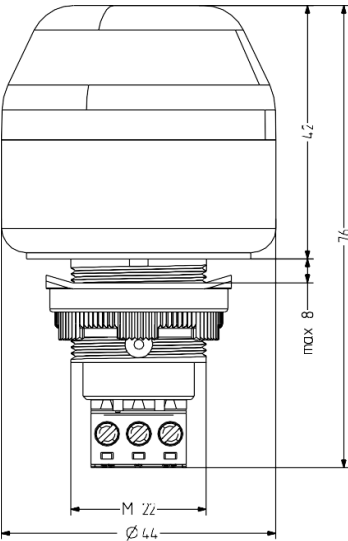

IDL

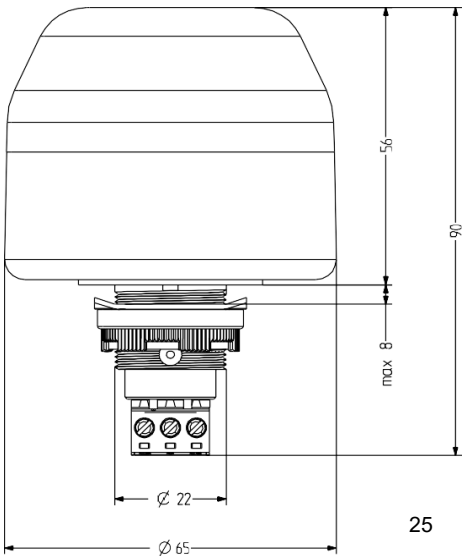

ITS / ITM / ITL M22 panel mount LED multi colour beacon

- Ø 30 mm | 1.18 Inch / Ø 45 mm | 1.77 Inch / Ø 65 mm | 2.56 Inch panel-mount LED multi-colour steady beacon
- RED and GREEN, can be switched externally
- Good signalling effect
- High degree of protection IP 65
- User-friendly connection technology
- Modern LED technology and electronics
- Other colour combinations available on request
- For industrial and general applications
- Panel size Ø 22.5 mm | 0.89 Inch/M22
- Adapter available for M30.5 mm | 1.2 Inch panel size



TECHNICAL DATA

Housing	Ø 30 mm 1.18 Inch / Ø 45 mm 1.77 Inch / Ø 65 mm 2.56 Inch, Polycarbonate black (RAL 9005) or grey (RAL 7035)
Lens	Polycarbonate, ribbed inside clear
Type of mounting	any
Panel size	22x1,5 0.87x0.06 Inch (M22) and 30.5 mm 1.2 Inch (with adapter), mounting depth 47 mm 1.85 Inch
Connection technology	Screw/plug-in terminal 2,5 mm ²
Leakage current	3 mA (PLC-suitable)
Beacon type	LED steady beacon – 2 colours visible in separate colour areas
Light source	6 / 9 / 12 LEDs
Strobe/flash frequency	1 Hz
Number of colours	2
Duty cycle	100%
Service life	Light source: 100.000 h
Operating temperature	-25°C/+50°C 13 °F / 122 °F
Degree of protection	IP65 & UL Type 4/4x/13
Weight	31 / 56 / 77 g 0.07 / 0.12 / 0.17 lbs



ITS

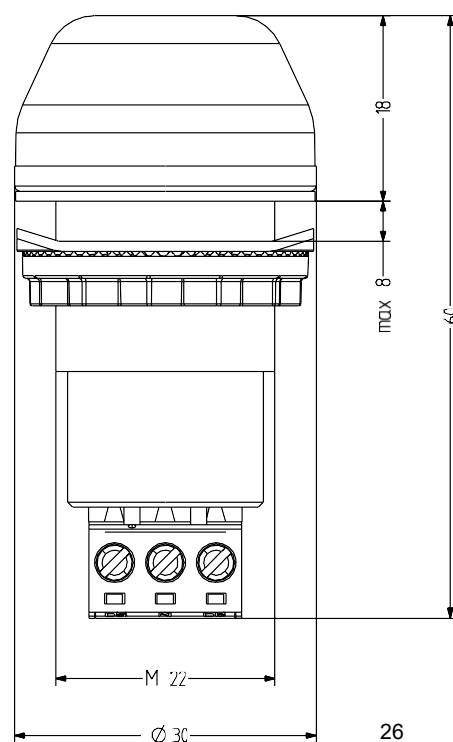

26

ITS / ITM / ITL Order numbers

ITS

Lens colour	Nominal voltage	Voltage range [V]	Nominal current [mA]	Housing colour	
				black	grey
clear	24 V AC/DC	+/- 10 %	30	800 726 405	800 326 405

ITM

Lens colour	Nominal voltage	Voltage range [V]	Nominal current [mA]	Housing colour	
				grey	black
clear	24 V AC/DC	+/- 10 %	39	801 326 405	801 726 405
	110-120 V AC	+/- 10 %	35	801 326 310	801 726 310
	230-240 V AC	+/- 10 %	35	801 326 313	801 726 313

ITL

Lens colour	Nominal voltage	Voltage range [V]	Nominal current [mA]	Housing colour	
				black	grey
clear	24 V AC/DC	+/- 10 %	44	802 726 405	802 326 405
	110-120 V AC	+/- 10 %	41	802 726 310	802 326 310
	230-240 V AC	+/- 10 %	41	802 726 313	802 326 313



ADM30



WZ30

ACCESSORIES

Type	Type of accessory	Weight	Order number
ADM30	Adapter for M30.5 mounting holes	8 g 0.02 lbs	812 500 900
WZ30	Mounting tool for M22 mounting products with Ø 30 mm 1.18 Inch		812 400 900
WM22	Metal bracket for products with M22 mounting thread	45 g 0.1 lbs	812 100 900
WM22I	Indoor Metal bracket for products with M22 mounting thread	45 g 0.1 lbs	812 100 910

ITM

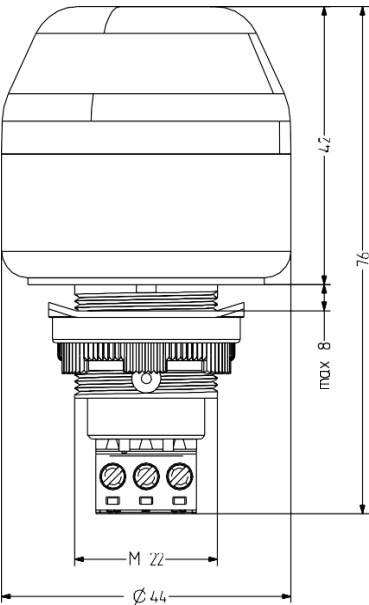

ITL

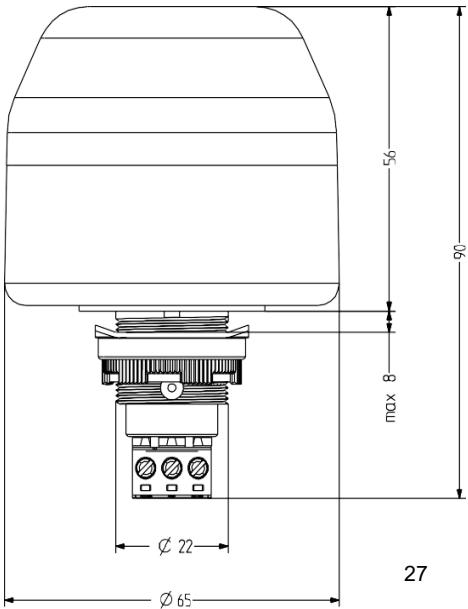

IMM / IML M22 panel mount LED multi colour beacon

- Ø 45 mm | 1.77 Inch / Ø 65 mm | 2.56 Inch panel-mount LED multi-colour steady beacon
- RED, YELLOW or GREEN, can be switched externally
- High degree of protection IP 67
- Prewired with 1 m UL cable
- Modern LED technology and electronics
- Good signalling effect
- For industrial and general applications
- Panel size Ø 22.5 mm | 0.89 Inch/M22
- Adapter available for M30.5 mm | 1.2 Inch panel size



TECHNICAL DATA

Housing	Ø 45 mm 1.77 Inch / Ø 65 mm 2.56 Inch, Polycarbonate black (RAL 9005) or grey (RAL 7035)
Lens	Polycarbonate, ribbed inside clear
Type of mounting	any
Panel size	22x1,25 mm 0.87x0.05 Inch (M22) and 30.5 1.2 Inch (with adapter), mounting depth 34 mm 1.34 Inch
Cable entry	pre-wired (1 m cable)
Leakage current	3 mA (PLC-suitable)
Beacon type	LED steady beacon - 3 colour beacon
Light source	9 / 12LEDs
Number of colours	3
Duty cycle	100% (one colour)
Service life	Light source: 100.000 h
Operating temperature	-25°C/+50°C 13 °F / 122 °F
Degree of protection	IP67 & UL Type 4/4x/13
Weight	97 / 117 g 0.21 / 0.26 lbs



IMM / IML Order numbers

IMM

Lens colour	Nominal voltage	Voltage range [V]	Nominal current [mA]	Housing colour	
				black	grey
clear	24 V AC/DC	+/- 10 %	27	801 550 405	801 150 405

IML

Lens colour	Nominal voltage	Voltage range [V]	Nominal current [mA]	Housing colour	
				grey	black
clear	24 V AC/DC	+/- 10 %	43	802 150 405	802 550 405
	110-120 V AC	+/- 10 %	33	802 150 310	802 550 310
	230-240 V AC	+/- 10 %	33	802 150 313	802 550 313



ADM30

ACCESSORIES

Type	Type of accessory	Weight	Order number
ADM30	Adapter for M30.5 mounting holes	8 g 0.02 lbs	812 500 900
WM22	Metal bracket for products with M22 mounting thread	45 g 0.1 lbs	812 100 900
WM22I	Indoor Metal bracket for products with M22 mounting thread	45 g 0.1 lbs	812 100 910

IMM

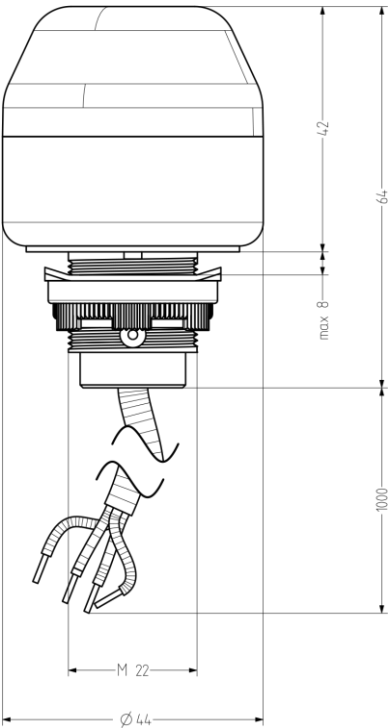

IML

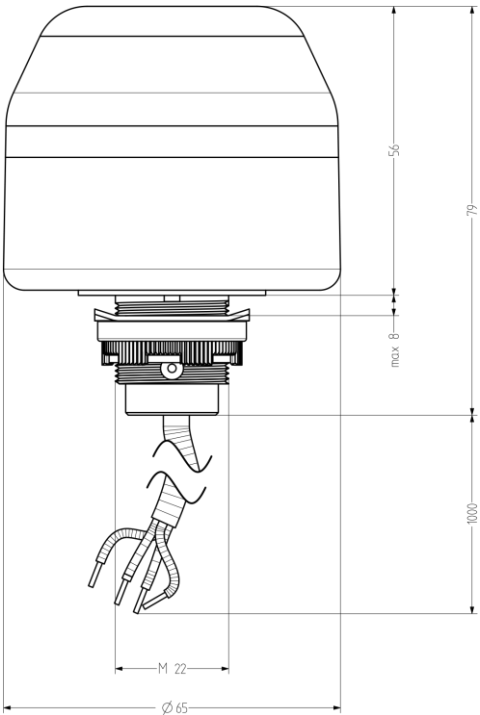

ESV Panel mount buzzer

- Ø 30 mm | 1.19 Inch panel-mount buzzer
- Max. 85 dB (A) sound pressure
- High degree of protection IP 65
- Panel size Ø 22.5 mm | 0.89 Inch/M22
- 2 easily distinguishable tones
- User-friendly connection technology
- For industrial and general applications
- Adapter available for M30.5 mm | 1.2 Inch panel size



TECHNICAL DATA

Housing	Ø 30 mm 1.18 Inch Polycarbonate black (RAL 9005) or grey (RAL 7035)
Type of mounting	any
Panel size	22 mm 0.87 Inch (M22) and 30.5 mm 1.2 Inch (with adapter)
Connection technology	plug-in screw terminal bis 2,5 mm²
Leakage current	3 mA
Tone	2 Tones, 2 Tones can be switched externally, Steady tone or Pulsing tone
Volume	85 dB
Tone Frequency	3.500 Hz
Duty cycle	100%
Operating temperature	-25 °C / +60 °C 13 °F / 140 °F
Degree of protection	IP65 & UL Type 4/4x/13
Weight	30 g 0.07 lbs

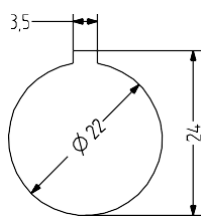
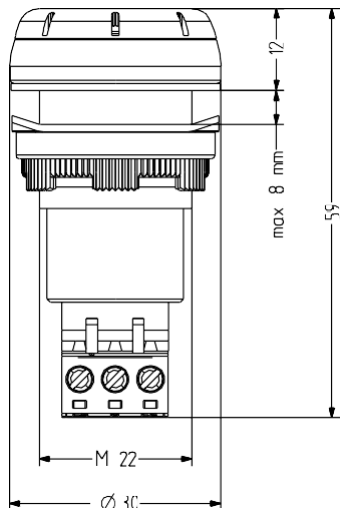

ESV

ORDER DATA

Nominal voltage	Voltage range (V)	Nominal current (mA)	Mains frequency	Housing colour	
				grey	black
12-24 V AC/DC	10-24	40	50-60 Hz	812 110 405	812 510 405
110-120 V AC	75-140	35	50-60 Hz	812 110 310	812 510 310
230 V AC	150-260	35	50-60 Hz	812 110 313	812 510 313



ADM30



WZ30

ACCESSORI S

Type	Type of accessory	Weight	Order number
ADM30	Adapter for M30.5 mounting holes	8 g 0.02 lbs	812 500 900
WZ30	Mounting tool for M22 mounting products with Ø 30 mm 1.18 Inch		812 400 900
WM22	Metal bracket for products with M22 mounting thread	45 g 0.1 lbs	812 100 900
WM22I	Indoor Metal bracket for products with M22 mounting thread	45 g 0.1 lbs	812 100 910

TONE TABLE

Tone on terminal			
La	N	Lb	
X	X		pulsing tone
X	X	X	continuous tone

ESK Panel mount buzzer

- Ø 30 mm | 1.18 Inch panel-mount buzzer
- Max. 65 dB (A) sound pressure
- High degree of protection IP 65
- Panel size Ø 22.5 mm | 0.89 Inch/M22
- 2 easily distinguishable tones
- User-friendly connection technology
- For industrial and general applications
- Adapter available for M30.5 mm | 1.2 Inch panel size



TECHNICAL DATA

Housing	Ø 30 mm 1.18 Inch Polycarbonate black (RAL 9005) or grey (RAL 7035)
Type of mounting	any
Panel size	22 mm 0.87 Inch (M22) and 30.5 mm 1.2 Inch (with adapter)
Connection technology	plug-in screw terminal bis 2,5 mm ²
Leakage current	3 mA
Tone	2 Tones, 2 Tones can be switched externally, Steady tone or Pulsing tone
Volume	65 dB
Tone frequency	3.500 Hz
Duty cycle	100%
Operating temperature	-25 °C / +60 °C 13 °F / 140 °F
Degree of protection	IP65 & UL Type 4/4x/13
Weight	30 g 0.07 lbs

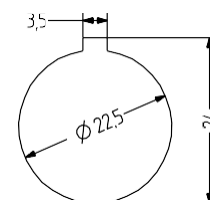
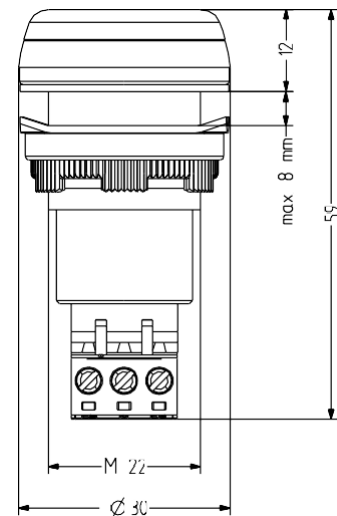

ESK

ORDER DATA

Nominal voltage	Voltage range (V)	Nominal current (mA)	Mains frequency	Housing colour	
				black	grey
12-24 V AC/DC	10-24	40	50-60 Hz	812 500 405	812 100 405
110-120 V DC	+/- 10 %	11	50-60 Hz	812 500 010	
110-120 V AC	75-140	35	50-60 Hz	812 500 310	812 100 310 Discontinued
230 V AC	150-260	35	50-60 Hz	812 500 313	812 100 313



ADM30



WZ30

ACCESSORIES

Type	Type of accessory	Weight	Order number
ADM30	Adapter for M30.5 mounting holes	8 g 0.02 lbs	812 500 900
WZ30	Mounting tool for M22 mounting products with Ø 30 mm 1.18 Inch		812 400 900
WM22	Metal bracket for products with M22 mounting thread	45 g 0.1 lbs	812 100 900

TONE TABLE

Tone on terminal			
La	N	Lb	
X	X		pulsing tone
X	X	X	continuous tone



ESM Panel mount buzzer

- Ø 45 mm | 1.77 Inch panel-mount buzzer
- Max. 100 dB (A) sound pressure, infinitely adjustable
- High degree of protection IP 65
- Panel size Ø 22.5 mm | 0.89 Inch/M22
- 2 easily distinguishable tones
- User-friendly connection technology
- For industrial and general applications
- Adapter available for M30.5 mm | 1.2 Inch panel size



TECHNICAL DATA

Housing	Ø 45 mm 1.77 Inch Polycarbonate black (RAL 9005) or grey (RAL 7035)
Type of mounting	any
Panel size	22 mm 0.87 Inch (M22) and 30.5 mm 1.2 Inch (with adapter)
Connection technology	plug-in screw terminal bis 2,5 mm ²
Leakage current	3 mA
Tone	2 Tones, 2 Tones can be switched externally, Steady tone or Pulsing tone
Volume	85-100 dB (can be adjusted with potentiometer)
Tone frequency	3.300 Hz
Duty cycle	100%
Operating temperature	-25 °C / +60 °C 13 °F / 140 °F
Degree of protection	IP65 & UL Type 4/4x/13
Weight	35 g 0.08 lbs

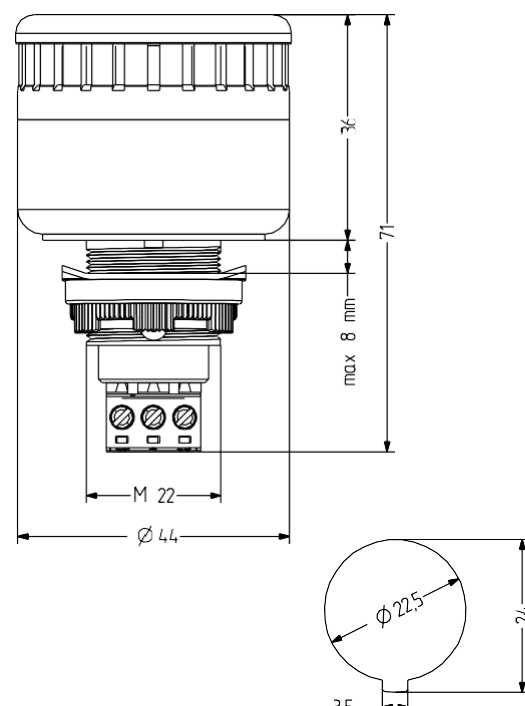

ESM

ORDER DATA

Nominal voltage	Voltage range (V)	Nominal current (mA)	Mains frequency	Housing colour	
				grey	black
12-24 V AC/DC	8-24	19	50-60 Hz	813 100 405	813 500 405
110-120 V AC	75-140	42	50-60 Hz	813 100 310	813 500 310
230 V AC	150-260	40	50-60 Hz	813 100 313	813 500 313



ADM30

ACCESSORIES

Type	Type of accessory	Weight	Order number
ADM30	Adapter for M30.5 mounting holes	8 g 0.02 lbs	812 500 900
WM22	Metal bracket for products with M22 mounting thread	45 g 0.1 lbs	812 100 900

TONE TABLE

Tone on terminal			
La	N	Lb	
X	X		pulsing tone
X	X	X	continuous tone

ESG Panel mount buzzer

- Ø 65 mm | 2.56 Inch panel-mount buzzer
- Max. 105 dB (A) sound pressure, infinitely adjustable
- High degree of protection IP 65
- Panel size Ø 22.5 mm | 0.89 Inch/M22

- 3 easily distinguishable tones
- User-friendly connection technology
- For industrial and general applications
- Adapter available for M30.5 mm | 1.2 Inch panel size



TECHNICAL DATA

Housing	Ø 65 mm 2.56 Inch Polycarbonate black (RAL 9005) or grey (RAL 7035)
Type of mounting	any
Panel size	22 mm 0.87 Inch (M22) and 30.5 mm 1.2 Inch (with adapter)
Connection technology	Plug-in screw terminal bis 2,5 mm²
Leakage Current	3 mA
Tone	3 Tones, 3 Tones can be switched externally, Steady tone, Pulsing tone or Alternating
Volume	85-105 dB (can be adjusted with potentiometer)
Tone frequency	3.300 Hz
Duty cycle	100%
Operating temperature	-25 °C / +60 °C 13 °F / 140 °F
Degree of protection	IP65 & UL Type 4/4x/13
Weight	65 g 0.14 lbs

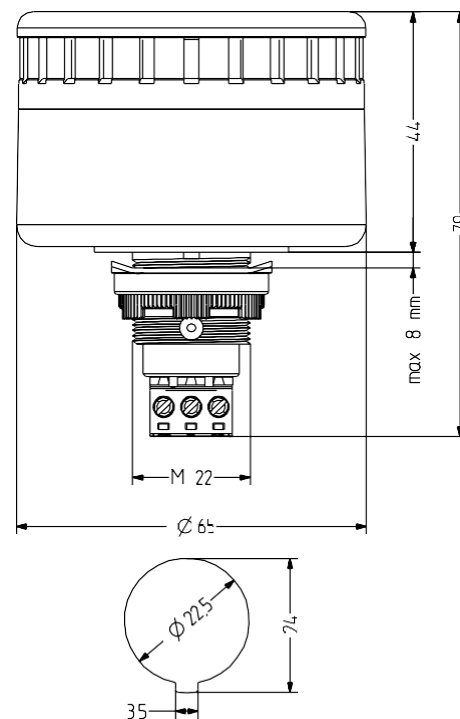

ESG

ORDER DATA

Nominal voltage	Voltage range (V)	Nominal current (mA)	Mains frequency	Housing colour	
				grey	black
12-24 V AC/DC	8-24	57	50-60 Hz	814 100 405	814 500 405
110-120 V AC	75-140	42	50-60 Hz	814 100 310	814 500 310
230 V AC	150-260	44	50-60 Hz	814 100 313	814 500 313



ADM30

ACCESSORIES

Type	Type of accessory	Weight	Order number
ADM30	Adapter for M30.5 mounting holes	8 g 0.02 lbs	812 500 900
WM22	Metal bracket for products with M22 mounting thread	45 g 0.1 lbs	812 100 900
WM22I	Indoor Metal bracket for products with M22 mounting thread	45 g 0.1 lbs	812 100 910

TONE TABLE

Tone on terminal			
La	N	Lb	
X	X		pulsing tone
	X	X	wobble tone
X	X	X	continuous tone

ELG LED panel mount buzzer

- Ø 65 mm | 2.56 Inch panel-mount buzzer with LED steady/flashing beacon
- Max. 103 dB (A) sound pressure, infinitely adjustable
- High degree of protection IP 65, user-friendly connection technology
- Panel size Ø 22.5 mm | 0.89 Inch/M22
- Pulsing or wobble tone with LED flashing light
- Steady tone with LED steady light
- Switching via terminal assignment
- For industrial and general applications
- Adapter available for M30.5 mm | 1.2 Inch panel size



TECHNICAL DATA

Housing	Ø 65 mm 2.56 Inch, Polycarbonate grey or black
Lens	Polycarbonate, ribbed inside amber, red, clear, blue, green or yellow
Type of mounting	any
Panel size	22 mm 0.87 Inch (M22) and 30.5 mm 1.2 Inch (with adapter)
Connection technology	Up to 2,5 mm ²
Beacon type	LED steady beacon or LED flashing beacon
Strobe/flash frequency	2 Hz
Tone	3 Tones, 3 Tones can be switched externally, Steady tone, Pulsing tone or Wobble tone
Volume	85-103 dB (can be adjusted when panel mounted)
Tone frequency	2.800 Hz
Duty cycle	100%
Service life	Light source: 100.000 h
Operating temperature	-25 °C / +60 °C 13 °F / 140 °F
Degree of protection	IP65
Weight	110 g 0.24 lbs

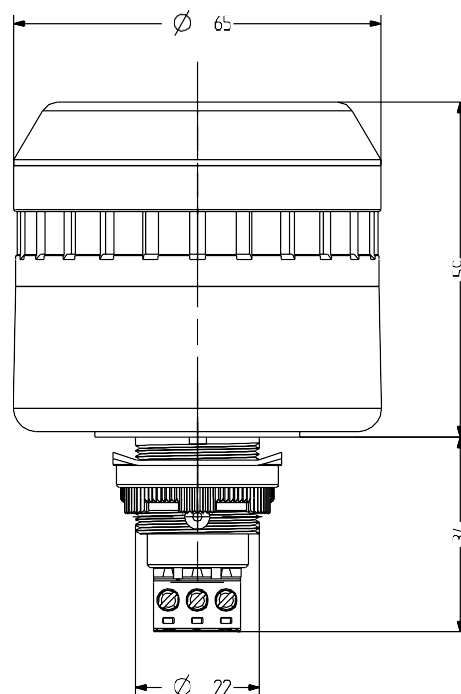

ELG

ORDER DATA

Lens colour	Nominal voltage	Voltage range [V]	Nominal current [mA]	Housing colour	
				grey	black
amber	12 V AC/DC	+/- 10 %	73	814 111 404	814 511 404
	24 V AC/DC	+/- 10 %	47	814 111 405	814 511 405
	110-120 V AC	+/- 10 %	60	814 111 310	814 511 310
	230-240 V AC	+/- 10 %	63	814 111 313	814 511 313
red	12 V AC/DC	+/- 10 %	73	814 112 404	814 512 404
	24 V AC/DC	+/- 10 %	47	814 112 405	814 512 405
	110-120 V AC	+/- 10 %	60	814 112 310	814 512 310
	230-240 V AC	+/- 10 %	63	814 112 313	814 512 313



ADM30

ACCESSORIES

Type	Type of accessory	Weight	Order number
ADM30	Adapter for M30.5 mounting holes	8 g 0.02 lbs	812 500 900
WM22	Metal bracket for products with M22 mounting thread	45g 0.1 lbs	812 100 900
WM22I	Indoor Metal bracket for products with M22 mounting thread	45 g 0.1 lbs	812 100 910

tone table

Tone and light selection on terminal			
La	N	Lb	Tone and light synchronized
X	X		pulsing tone / LED flashing light
	X	X	wobble tone / LED flashing light
X	X	X	continuous tone / steady light

EDG LED panel mount buzzer

- Ø 65 mm | 2.56 Inch panel-mount buzzer with LED steady beacon
- Max. 103 dB (A) sound pressure, infinitely adjustable
- High degree of protection IP 65
- Panel size Ø 22.5 mm | 0.89 Inch/M22
- Steady tone and LED steady light, can be switched separately
- Switching via terminal assignment
- User-friendly connection technology
- For industrial and general applications
- Adapter available for M30.5 mm | 1.2 Inch panel size



TECHNICAL DATA

Housing	Ø 65 mm 2.56 Inch, Polycarbonate grey or black
Lens	Polycarbonate, ribbed inside amber or red
Type of mounting	any
Panel size	22 mm 0.87 Inch (M22) and 30.5 mm 1.2 Inch (with adapter)
Connection technology	up to 2,5 mm ²
Beacon type	LED steady beacon
Tone	2 Tones, Steady tone
Volume	85-103 dB (can be adjusted when panel mounted)
Tone frequency	2.800 Hz
Duty cycle	100%
Service life	Light source: 100.000 h
Operating temperature	-25 °C / +60 °C 13 °F / 140 °F
Degree of protection	IP65
Weight	100 g 0.22 lbs

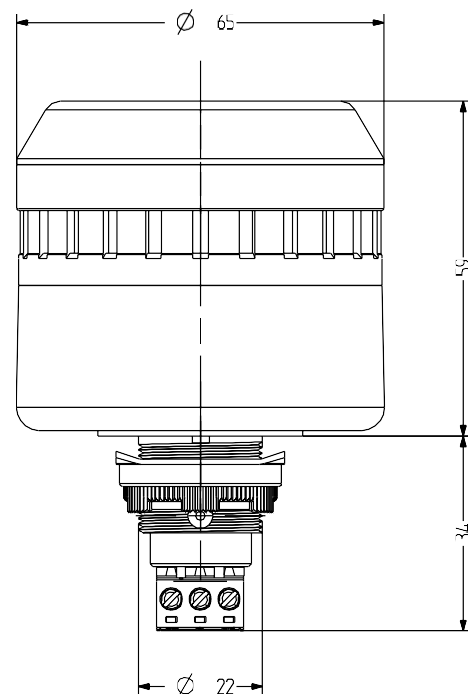
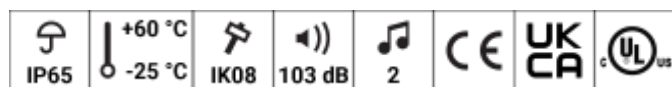

EDG

ORDER DATA

Lens colour	Nominal voltage	Voltage range [V]	Nominal current [mA]	Housing colour	
				grey	black
amber	12 V AC/DC	+/- 10 %	62	814 121 404	814 521 404
	24 V AC/DC	+/- 10 %	95	814 121 405	814 521 405
	110-120 V AC	+/- 10 %	52	814 121 310	814 521 310
	230-240 V AC	+/- 10 %	52	814 121 313	814 521 313
red	12 V AC/DC	+/- 10 %	62	814 122 404	814 522 404
	24 V AC/DC	+/- 10 %	95	814 122 405	814 522 405
	110-120 V AC	+/- 10 %	52	814 122 310	814 522 310
	230-240 V AC	+/- 10 %	52	814 122 313	814 522 313



ADM30

ACCESSORIES

Type	Type of accessory	Weight	Order number
ADM30	Adapter for M30.5 mounting holes	8 g 0.02 lbs	812 500 900
WM22	Metal bracket for products with M22 mounting thread	45 g 0.1 lbs	812 100 900
WM22I	Indoor Metal bracket for products with M22 mounting thread	45 g 0.1 lbs	812 100 910

TONE TABLE

Tone setting			
La	N	Lb	Tone and light seperately switchable
X	X		continous tone
	X	X	steady light

ELM LED panel mount buzzer

- Ø 45 mm | 1.77 Inch panel-mount buzzer with LED steady/flashing beacon
- Max. 98 dB (A) sound pressure, infinitely adjustable
- High degree of protection IP 65, user-friendly connection technology
- Panel size Ø 22.5 mm | 0.89 Inch/M22
- Pulsing tone with LED flashing light
- Steady tone with LED steady light
- Switching via terminal assignment
- For industrial and general applications
- Adapter available for M30.5 mm | 1.2 Inch panel size



TECHNICAL DATA

Housing	Ø 45 mm 1.77 Inch, Polycarbonate grey or black
Lens	Polycarbonate, ribbed inside amber, red, clear, blue, green or yellow
Type of mounting	any
Panel size	22 mm 0.87 Inch (M22) and 30.5 mm 1.2 Inch (with adapter)
Connection technology	up to 2,5 mm²
Beacon type	LED steady beacon or LED flashing beacon
Strobe/flash frequency	2 Hz
Tone	2 Tones, 2 Tones can be switched externally, Steady tone or Pulsing tone
Volume	85-98 dB (can be adjusted when panel mounted)
Tone frequency	3.500 Hz
Duty cycle	100%
Service life	Light source: 100.000 h
Operating temperature	-25 °C / +60 °C 13 °F / 140 °F
Degree of protection	IP65
Weight	65 g 0.14 lbs

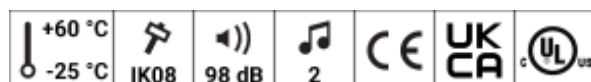
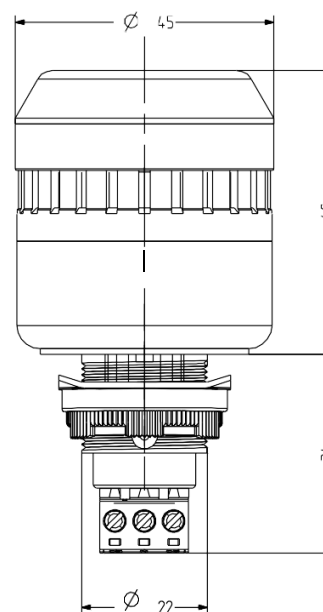

ELM

ORDER DATA

Lens colour	Nominal voltage	Voltage range (V)	Nominal current (mA)	Housing colour	
				black	grey
amber	12 V AC/DC	+/- 10 %	35	813 511 404	813 111 404
	24 V AC/DC	+/- 10 %	58	813 511 405	813 111 405
	110-120 V AC	+/- 10 %	42	813 511 310	813 111 310
	230-240 V AC	+/- 10 %	40	813 511 313	813 111 313
red	12 V AC/DC	+/- 10 %	35	813 512 404	813 112 404
	24 V AC/DC	+/- 10 %	58	813 512 405	813 112 405
	110-120 V AC	+/- 10 %	42	813 512 310	813 112 310
	230-240 V AC	+/- 10 %	40	813 512 313	813 112 313



ADM30

ACCESSORIES

Type of accessory	Weight	Order number
ADM30 Adapter for M30.5 mounting holes	8 g 0.02 lbs	812 500 900
WM22 Metal bracket for products with M22 mounting thread	45 g 0.1 lbs	812 100 900

TONE TABLE

Tone and light selection on terminal			
La	N	Lb	Tone and light synchronized
X	X		pulsing tone / LED flashing light
X	X	X	continuous tone / steady light

EDM LED panel mount buzzer

- Ø 45 mm | 1.77 Inch panel-mount buzzer with LED steady beacon
- Max. 98 dB [A] sound pressure, infinitely adjustable
- High degree of protection IP 65
- Panel size Ø 22.5 mm | 0.89 Inch/M22

- Steady tone and LED steady light, can be switched separately
- Switching via terminal assignment
- User-friendly connection technology
- For industrial and general applications
- Adapter available for M30.5 mm | 1.2 Inch panel size



TECHNICAL DATA

Housing	Ø 45 mm 1.77 Inch, Polycarbonate grey or black
Lens	Polycarbonate, ribbed inside, amber, red
Type of mounting	any
Panel size	22 mm 0.87 Inch (M22) and 30.5 mm 1.2 Inch (with adapter)
Connection technology	up to 2,5 mm²
Beacon type	LED steady beacon
Tone	2 Tones, Steady tone
Volume	85-98 dB (can be adjusted when panel mounted)
Tone frequency	3.500 Hz
Duty cycle	100 %
Service life	Light source: 100.000 h
Operating temperature	-25 °C / +60 °C 13 °F / 140 °F
Degree of protection	IP65
Weight	65 g 0.14 lbs

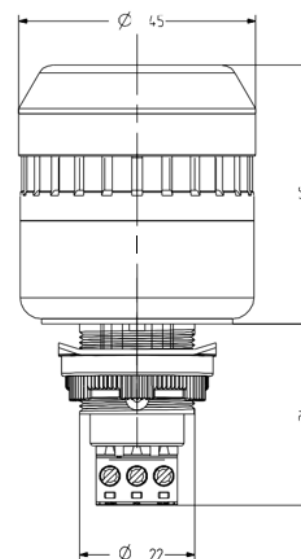

EDM

ORDER DATA

Lens colour	Nominal voltage	Voltage range (V)	Nominal current (mA)	Housing colour	
				black	grey
amber	12 V AC/DC	+/- 10 %	48	813 521 404	813 121 404
	24 V AC/DC	+/- 10 %	73	813 521 405	813 121 405
	110-120 V AC	+/- 10 %	51	813 521 310	813 121 310
	230-240 V AC	+/- 10 %	51	813 521 313	813 121 313
red	12 V AC/DC	+/- 10 %	48	813 522 404	813 122 404
	24 V AC/DC	+/- 10 %	73	813 522 405	813 122 405
	110-120 V AC	+/- 10 %	51	813 522 310	813 122 310
	230-240 V AC	+/- 10 %	51	813 522 313	813 122 313



ADM30

ACCESSORIES

Type	Type of accessory	Weight	Order number
ADM30	Adapter for M30.5 mounting holes	8 g 0.02 lbs	812 500 900
WM22	Metal bracket for products with M22 mounting thread	45 g 0.1 lbs	812 100 900
WM22I	Indoor Metal bracket for products with M22 mounting thread	45 g 0.1 lbs	812 100 910

TONE TABLE

Tone setting			
La	N	Lb	Tone and light seperately switchable
X	X		continous tone
	X	X	steady light